

# ROOM THERMOSTATS

## USE

-Room thermostats to control ambient temperature in HVAC installations.

## INSTALLATION AND OPERATION

-Stainless steel electrically welded membrane operated by vapour pressure.

## TECHNICAL FEATURES

- Base, cover and knob in thermoplastic material.
- 2 wire connection.
- Action type : 1B
- Protection class : I
- Test class : II
- Several control and signal options are available.
- Small and compact

## HOMOLOGATION AND STANDARDS

-Complies with CEI EN 60730-1 standards

## ELECTRICAL FEATURES

- Snap action SPDT microswitch with AgCdO contacts.
- Contact rating : 10(2.5)A 250Vac
- When temperature rises: 1-2 opens 1-4 closes

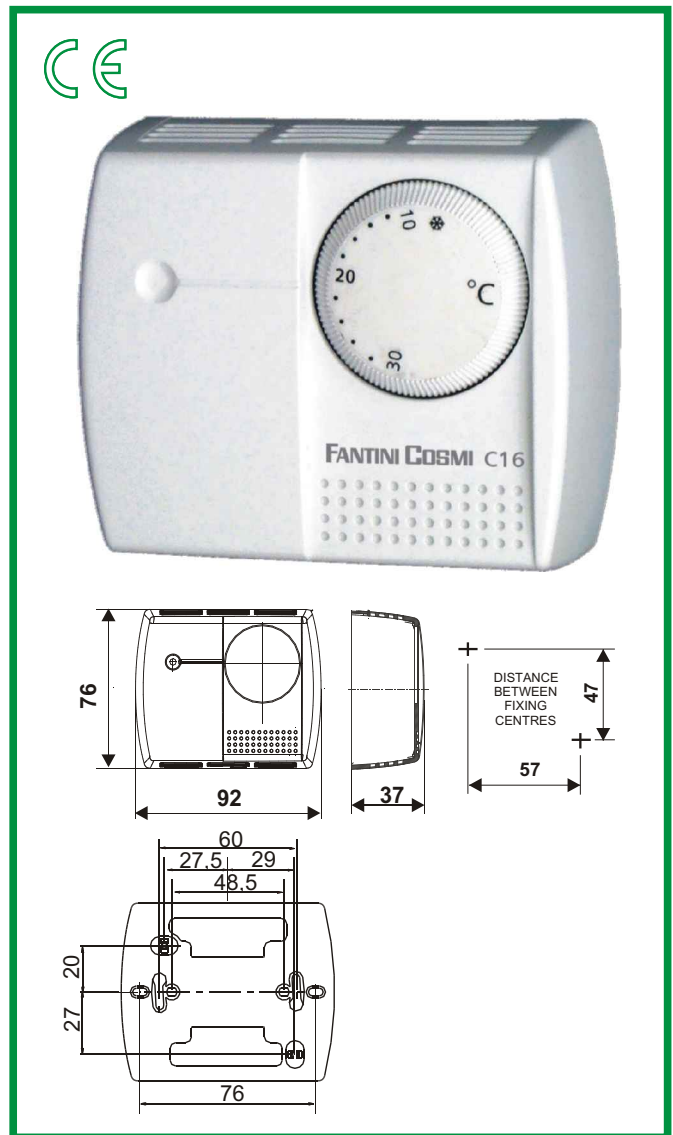
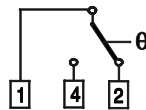

TYPE	Range °C	Differential K *	Max allowable thermostat body temp °C ♦	Max element temperature °C	Protection	Weight Kg	Box pcsi N°
<b>C16</b>	10 to 30	0.8	-10 to 50	45	IP20 (Normal pollution)	0.09	
<b>TC16</b>	Frame for mounting on: round box 60 mm, screw fixing round box with clips (not supplied) round box distance between centres 75 mm						

- \* The differential value must be deducted from the set value
- ♦ Differential values are referred to a temperature rising speed of 4 K/hour in air
- ♦ Transport and storage temperatures are equivalent to the max. allowable thermostat body temperature

## TEMPERATURE RANGE LIMITATION

Thermostat supplied with 2 pins to allow limitation of the temperature range.

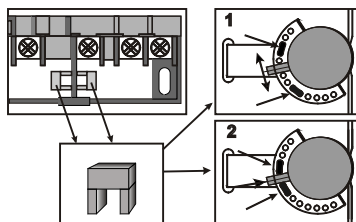

## EXAMPLE: ELECTRICAL WIRING

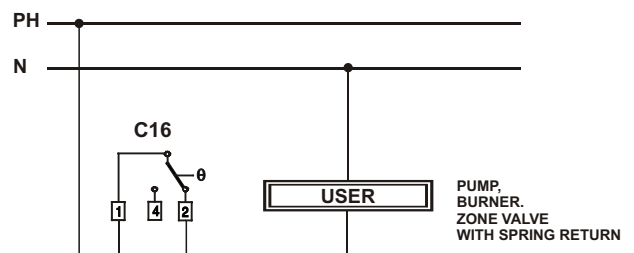

# ROOM THERMOSTAT CONTROL OPTIONS

C16 series thermostats are available with several control and signal options; technical details and range remain unchanged.



TYPE	DESCRIPTION	CONNECTION EXAMPLE
C16L	WITH LAMP	
C16I	WITH ON-OFF SWITCH	
C16IL	WITH ON-OFF SWITCH AND LAMP	
C16EH	WITH SUMMER-WINTER SWITCH	
C16EHL	WITH SUMMER-WINTER SWITCH AND LAMP	