

Sleeve temperature sensors / cable temperature sensors
 with passive output

S+S REGELTECHNIK

The sleeve sensor / cable temperature sensor THERMASGARD® HTF is used for the detection of temperatures in liquid and gaseous media, e.g. by installing it in an immersion sleeve. The cable sensor can be implemented as immersion or duct sensor, with silicone, glass fibre, or PVC leads, for two-wire, three-wire, or four-wire connection, depending on the application. The sleeve length varies, depending on request, from 30...500 mm (standard is 50 mm respectively 200 mm), the cable length is arbitrary (standard is 1.5 m).

HTF 200
 (NL = 200 mm, including mounting flange)
 as duct temperature sensor

TECHNICAL DATA:

Measuring ranges: -35 ...+105 °C PVC, LiYY, 2x0.25 mm²
 -50 ...+180 °C Silicone, SiHF, 2x0.25 mm²
 -50 ...+250 °C Teflon, SiHF, 2x0.25 mm²
 -50 ...+350 °C glass fibre, 2x0.25 mm²
 ends stripped with wire end sleeves
 (extended measuring range limits optional,
 depending on connection leads,
 $T_{max} \text{ NTC} = 150^{\circ}\text{C}$, $T_{max} \text{ LM235Z} = 125^{\circ}\text{C}$, $T_{max} \text{ Ni1000} = 180^{\circ}\text{C}$)

Sensors / output: see table, passive
 (optional also with 2 sensors)

Connection type: 2-wire connection
 (4-wire connection optional)

Testing current: ca. 1 mA

Protective tube: stainless steel, 1.4571, V4A
 (sensor sleeve) $\varnothing = 6 \text{ mm}$, nominal length NL = 50 mm (HTF50)
 respectively 200 mm (HTF200)
 (optional also other dimensions, NL = 30 ... 500 mm)

Sensor cable: length KL = 1.5 m
 (other lengths and diverse materials see table)

Insulating resistance: $\geq 100 \text{ M}\Omega$, at 20 °C (500 V DC)

Process connection: by mounting flange, plastic
 (for HTF200 included in the scope of delivery)
 (galvanised steel optional, see accessories)

Protection class: III (according to EN 60 730)

Protection type: IP 65 (according to EN 60529) rolled / stamped humidity-tight
 IP 68 (optional) sensor sleeve compound-filled



1x two-wire connection
standard

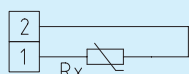

1x two-wire connection
LM 235Z (KP 10)

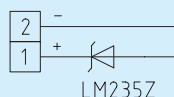

1x three-wire connection
 (optional)

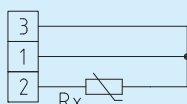

1x four-wire connection
 (optional)

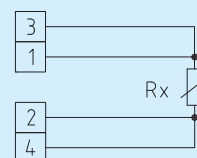

THERMASGARD® HTF 200 (NL = 200 mm, KL = 1.5 m), including mounting flange

Type / WG1 - Sensor / Output Features	PVC Rolled / Stamped	Silicone up to +180 °C	Teflon up to +250 °C	Silicone Humidity-Tight	Glass Fibre up to +350 °C
HTF200 Pt100	●	●	-	-	-
HTF200 Pt1000	●	●	-	-	-
HTF200 Ni1000	●	●	-	-	-
HTF200 Ni1000 TK5000, LG-Ni1000	●	●	-	-	-
HTF200 NTC 1.8 kOhm	●	●	-	-	-
HTF200 KTY81-210, NTC 10k, 20k, 30k, 50k, 10k Precon	●	●	-	-	-
HTF200 LM235Z (TCR = 10 mV / K, 2.73 V at 0 °C), KP10	●	●	-	-	-
Extra charge:	2-wire connecting leads, PVC, per running meter 2-wire connecting leads, silicone, per running meter				
Accessories:	MF-06-K Mounting flange, plastic (included in the scope of delivery) TH Immersion sleeves see last chapter				
For special orders please specify:	Type, sensor length (NL), material of leads, connection type, cable length (KL) e.g. HTF-300mm, Pt1000, PVC, 3-wire, 1.5 m; HTF-500mm, Pt100, silicone, 2-wire, 6 m				

Dimensional drawing

HTF

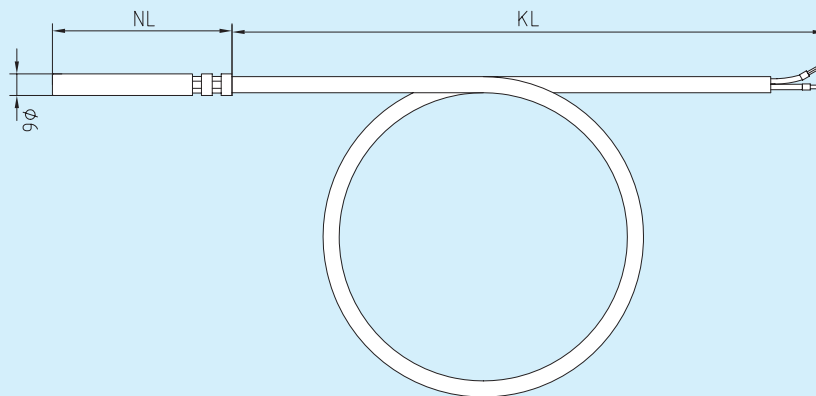

Dimensional drawing

MF-06-K

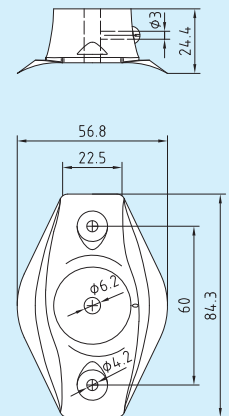
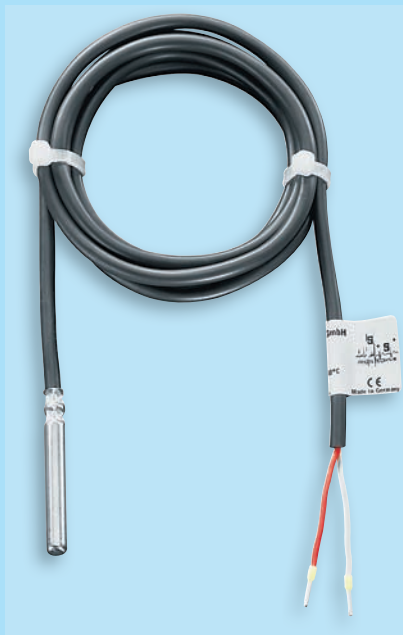
HTF 50
(NL = 50 mm)

HTF 50
(NL = 50 mm, with glass fibre cable)

MF-06-K
Mounting flange, plastic

THERMASGARD® HTF 50 (NL = 50 mm, KL = 1.5 m)

Type / WG1 - Sensor / Output Features	PVC Rolled / Stamped	Silicone up to +180 °C	Teflon up to +250 °C	Silicone Humidity-Tight	Glass Fibre up to +350 °C
HTF 50 Pt100	●	●	●	●	●
HTF 50 Pt1000	●	●	●	●	●
HTF 50 Ni1000	●	●	-	●	-
HTF 50 Ni1000 TK5000, LG-Ni1000	●	●	-	●	-
HTF 50 NTC 1.8 kOhm	●	●	-	●	-
HTF 50 KTY 81-210, NTC 10k, 20k, 30k, 50k, 10k Precon	●	●	-	●	-
HTF 50 LM235Z (TCR = 10 mV / K, 2.73 V at 0 °C), KP10	●	●	-	●	-
Extra charge:	2-wire connecting leads, PVC, per running meter 2-wire connecting leads, silicone, per running meter 2-wire connecting leads, Teflon, per running meter 2-wire connecting leads, glass fibre, per running meter				
Accessories:	MF-06-K Mounting flange, plastic TH Immersion sleeves see last chapter				
For special orders please specify:	Type, sensor length (NL), material of leads, connection type, cable length (KL) e.g. HTF-30mm, Pt1000, PVC, 3-wire, 1.5 m; HTF-40mm, Pt100, glass fibre, 2-wire, 6 m				